

Block Diagram

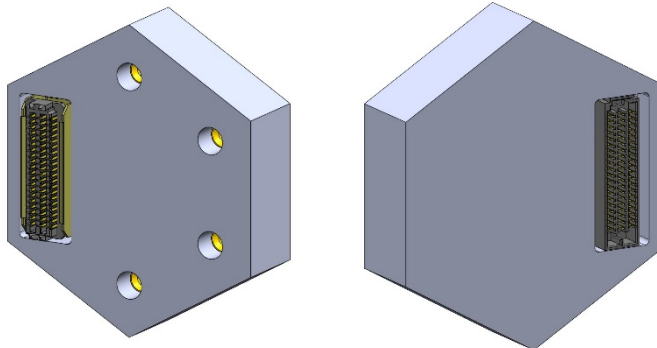

Features

- 30MHz – 6GHz System-on-Module
- 2x2 MIMO transceiver
- ADRV9002 Agile Transceiver™ with the Xilinx ZYNCR®-UltraScale+ SoC
- Instantaneous channel bandwidth up to 40MHz

Description

AS-00116-A is a powerful System-on-Module operating from 30MHz up to 6GHz. The RF heart of the AS-00116-A is the Analog Device ADRV9002 Agile Transceiver equipped with two RX and TX path, integrated LO synthesizer and high speed digitizer. The AS-00116-A is equipped with a Xilinx ZYNCR®- UltraScale+ SoC fully configurable to control the ADRV and to manage the digitalized data. The AS-00116-A is fully controllable via Linux, using a shell or via MATLAB, Simulink, GNU Radio. Dedicated Board Support packages are available to simplify the FW/SW development setup.

Module Specifications

Parameter	Typ.	Unit
RF Operating Frequencies	40 ÷ 6000	MHz
MIMO	2 RX x 2 TX	
RF I/O Interfaces	4 x SMP	
Data / Power Input Interface	SAMTEC SEAM 120pin	
Data / Power Output Interface	SAMTEC SEAF 120pin	
System Common Interface	SAMTEC SEAF 120pin	
Dimensions	7 x 7 x 1,5 (L x W x H)	cm



Advanced Technology Applications

AS-00116-A
30MHz - 6000MHz SoM Block
